

MAXIBLUE[®]

PRO



SPECIFIERS GUIDE

The BlueDiamond[®] pump range out performs other condensate pumps, can be mounted in any orientation and does exactly what you need it to do.

PG 1. SUMMARY

PG 2. CONSULTANTS TEXT & PUMP DIMENSIONS

PG 3. RESERVOIR DIMENSIONS

PG 4. POWER CONSUMPTION & INSTALLATION OPTION

PG 5. RESERVOIR WIRING DIAGRAM

PG 6. FITTING OF DRIAN PIPE ADAPTOR

PG 7. SAFETY INFORMATION

SUMMARY

PERFORMANCE

 21 dba

MAX FLOW	MAX HEAD	MAX LIFT
14 L/ HOUR	8 METRES	8 METRES

Designed for high humidity environments and with high performance, the MAXIBLUE[®] PRO is ideally suited for mid range air conditioning systems. Its exceptional reliability is backed by a multi year warranty and with class leading performance/suction lift, the MaxiBlue[®] is ideal for installations in environments that are both demanding and expensive to access for maintenance.

SENSING OPTION

MaxiBlue[®] pump available with:

RESERVOIR

X87-707

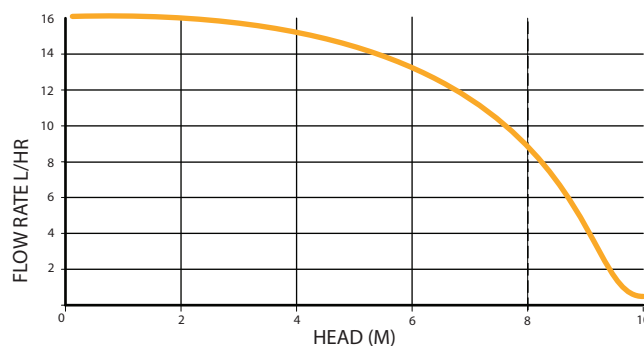
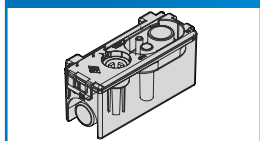

IN THE BOX

- 1x Pump – with 2.5m Mains cable + 5m Alarm cable
- 1x Reservoir
- 2x Mounting feet
- 1x Blue stepped connector
- 1x Black stepped connector
- 1x 24m of 6.3mm ID braided PVC discharge hose (marked at meter intervals)
- 1x Soil pipe adaptor
- 2x D14 Unex clip

DIMENSIONS (MM)

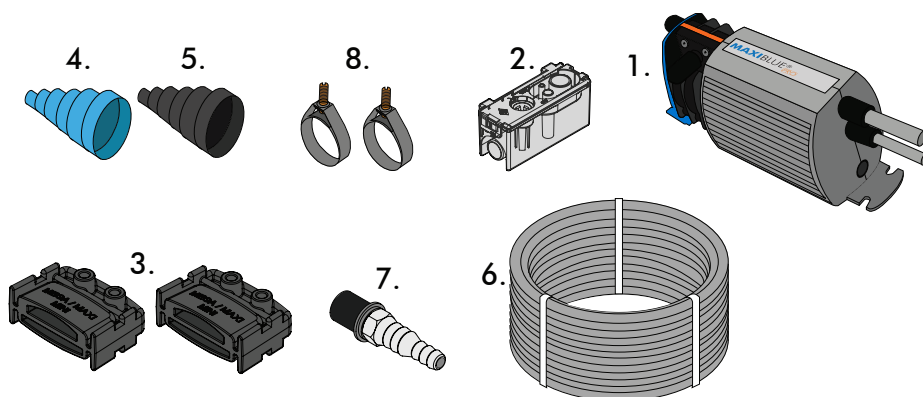
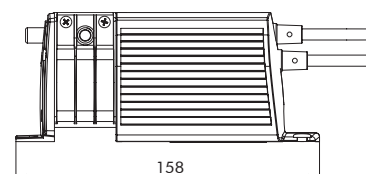
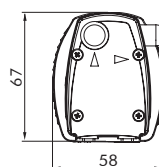

CONSULTANTS TEXT

"Fan coil units shall be provided with MAXIBLUE® PRO (X87-707) self priming condensate pumps manufactured by Charles Austen Pumps Ltd, Royston Road, Byfleet, Surrey, KT14 7NY, www.bluediamondpump.com, complete with elastomeric rotary diaphragm, solid state reservoir sensors with alarm contact for pump control and high level alarm (HLA). The condensate pumps shall be permanently live so the operate when the FCU's are switched off. Fault alarm cables from the condensate pumps shall be connected to the building's BMS system.

Pump drainage lines will be run in 1/4" ID PVC tubing and not exceed 24m or the horizontal 8m on the vertical discharge side."

DIMENSIONS (MM)

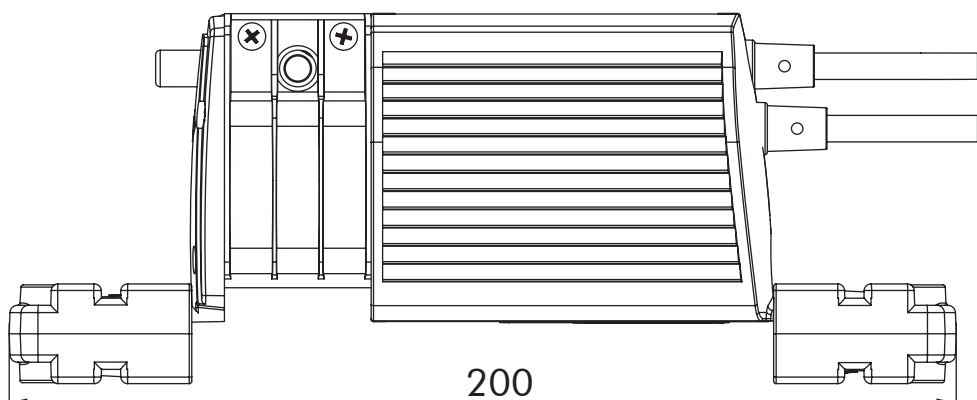
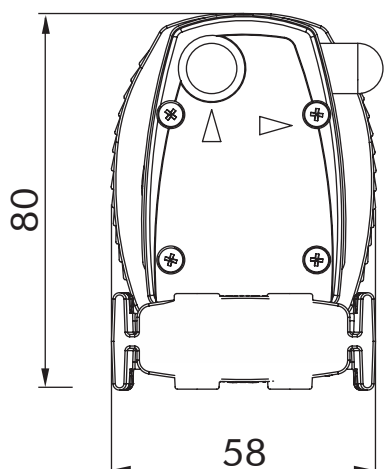
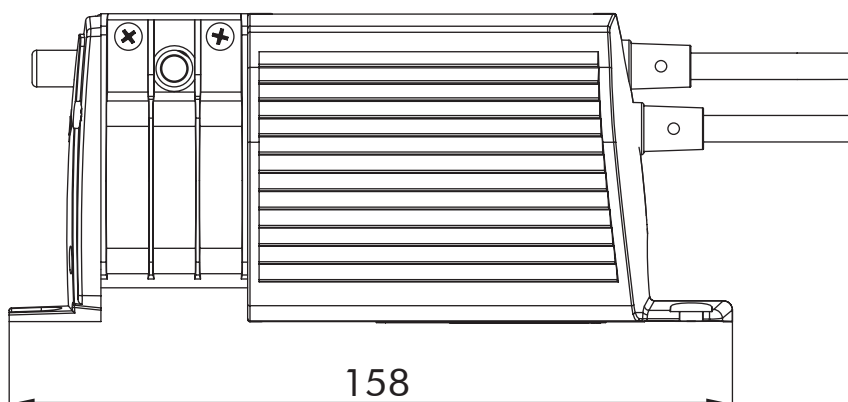
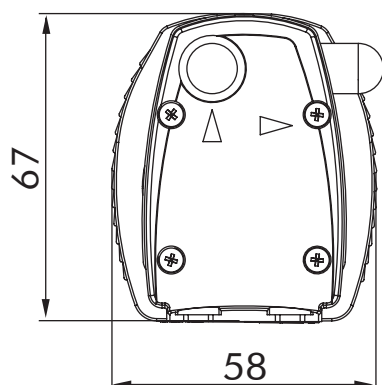

RESERVOIR DIMENSIONS (MM)

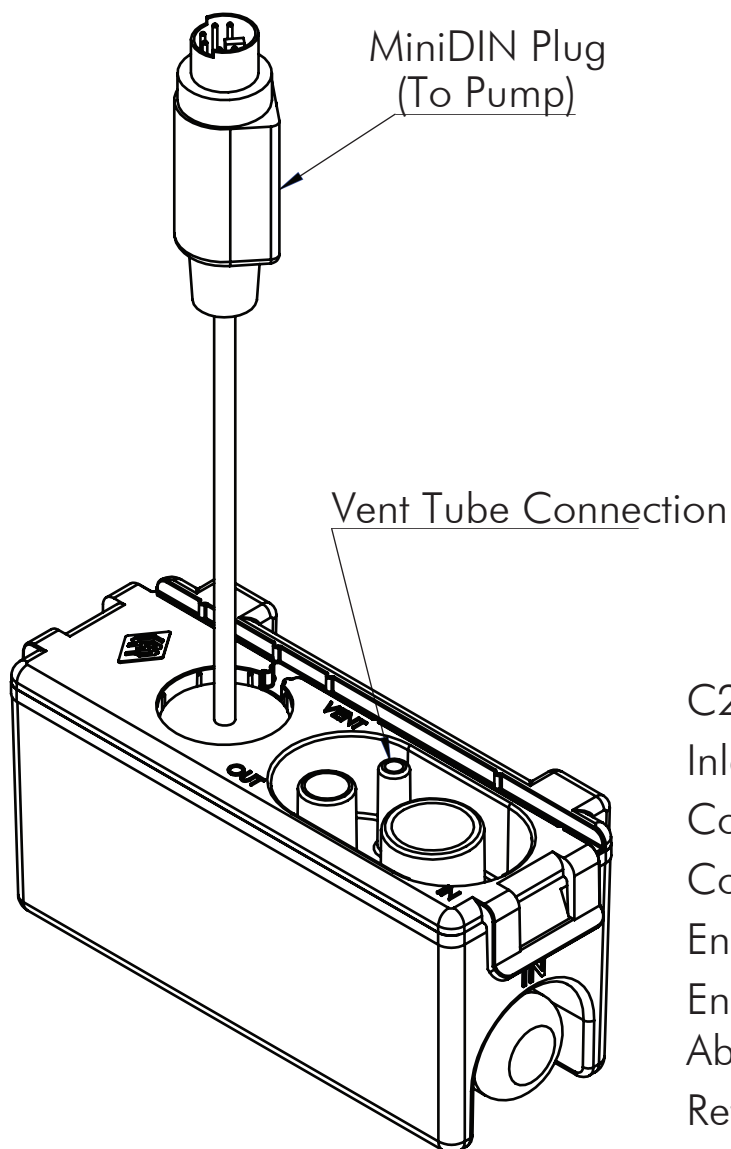
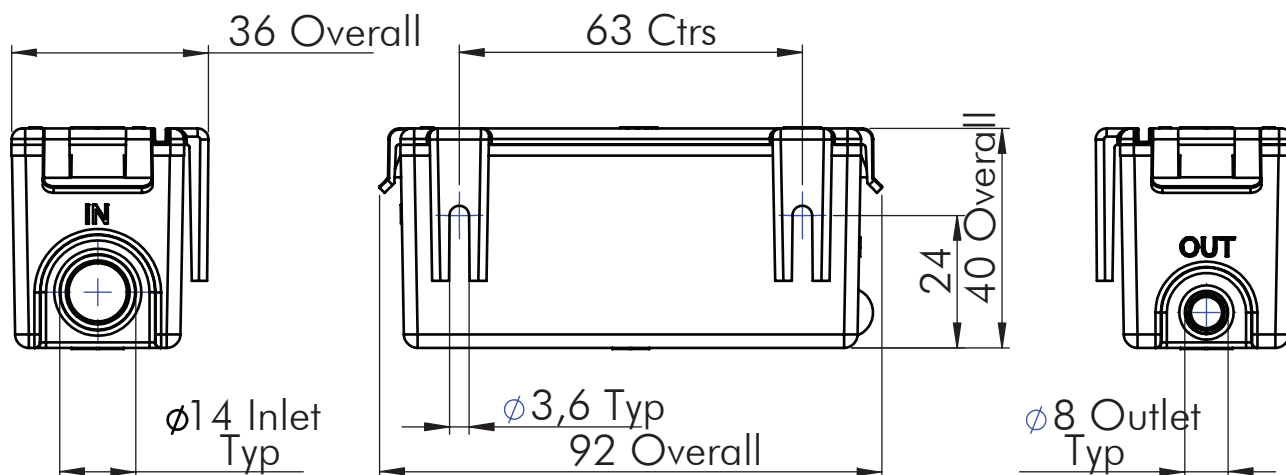

C21-013 Reservoir

Inlet / Outlet Locations May Be Reversed

Condensate Volume to Motor Start 15ml

Condensate Volume to Alarm Condition 40ml

Ensure Reservoir is Level & Secured

Ensure Vent Tube (Not Shown) Extends
Above Top of Drain Pan

Refer to Pump Manual For Further Details

POWER CONSUMPTION

VOLTS - 240V

FREQUENCY - 50 Hz

CURRENT DRAW - 0.02 Amps

POWER - 4.7 Watts

POWER FACTOR - 0.93



INSTALLATION OPTIONS

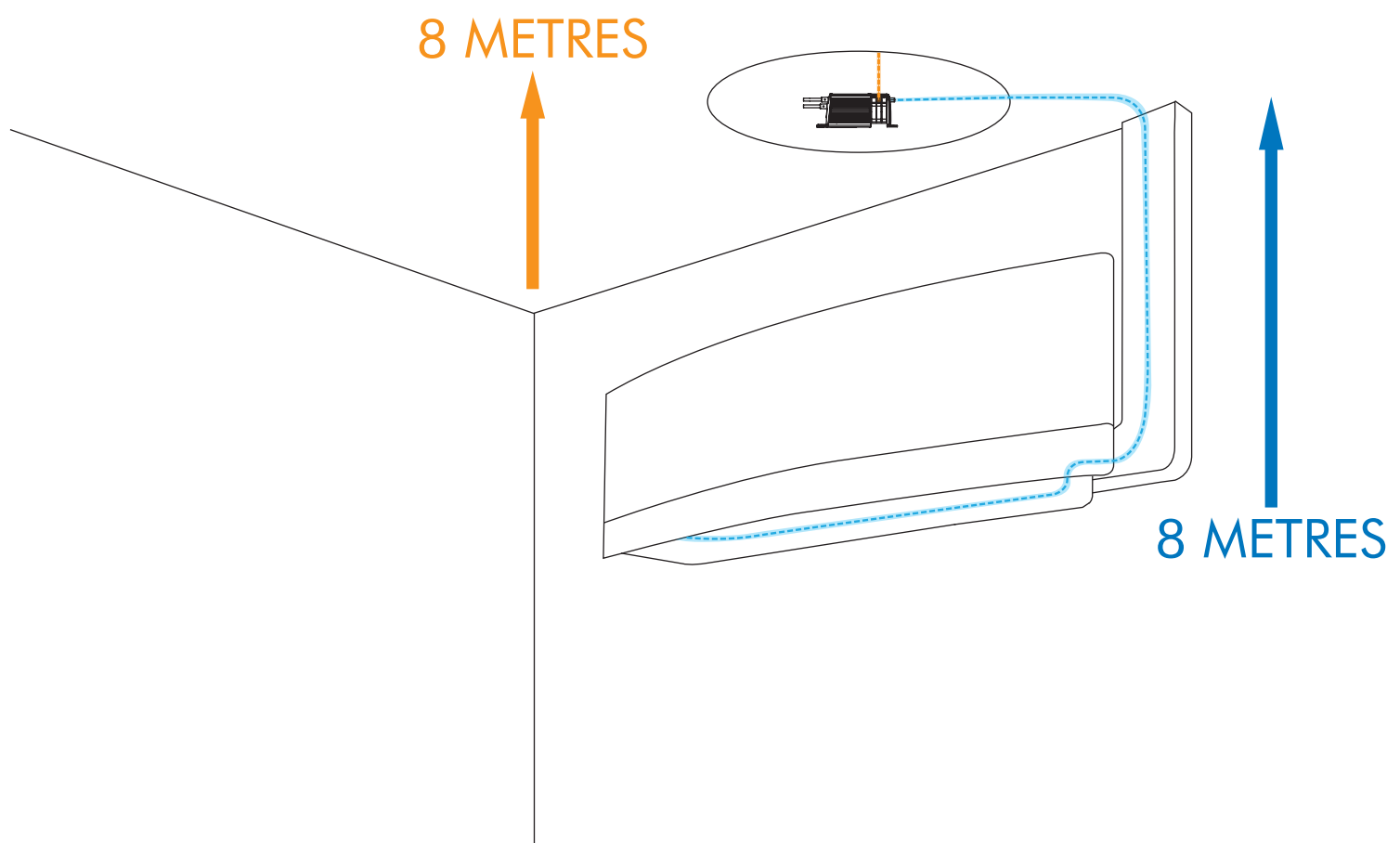

RESERVOIR WIRING DIAGRAM

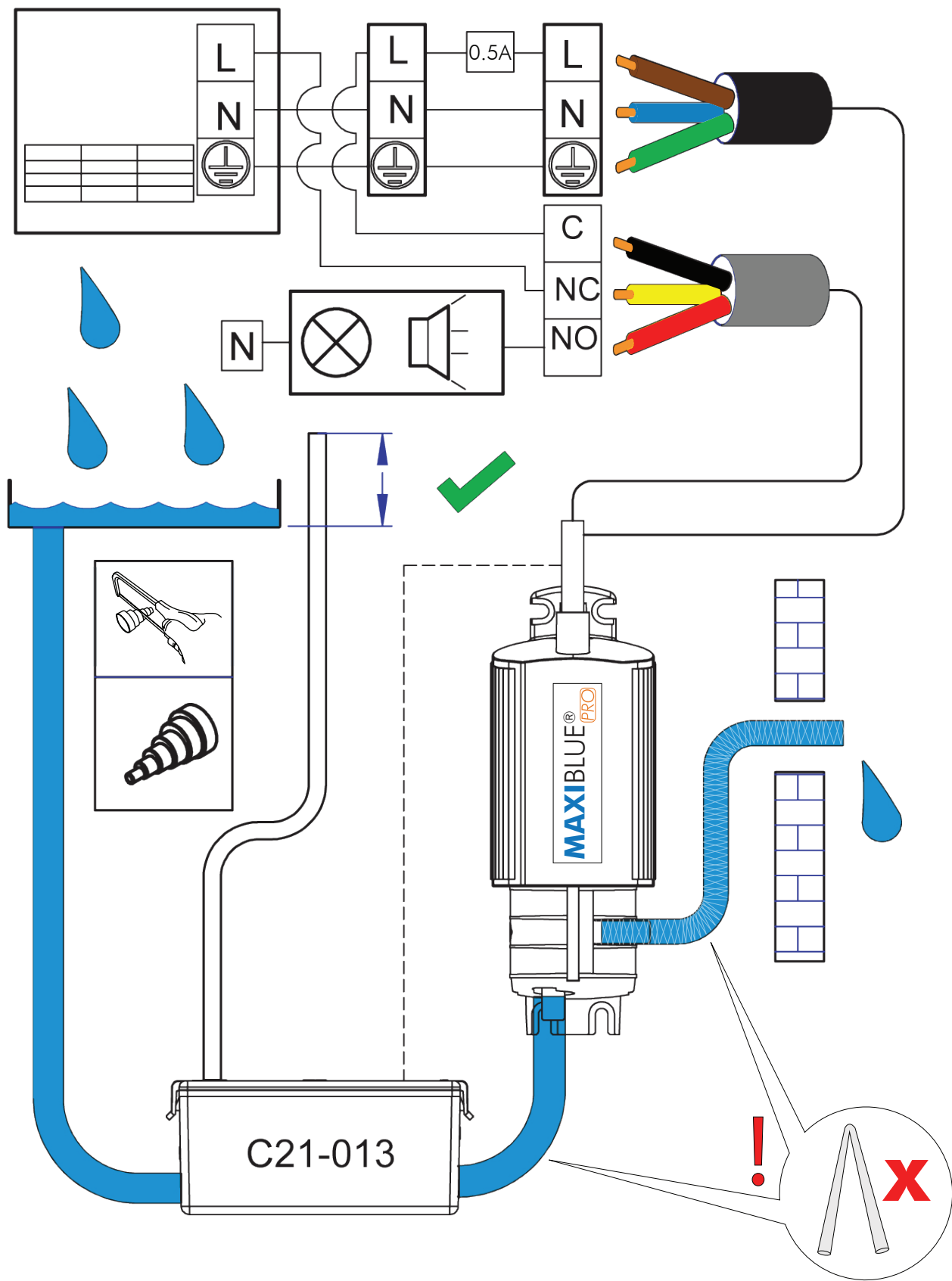

FITTING OF DRAIN PIPE ADAPTER

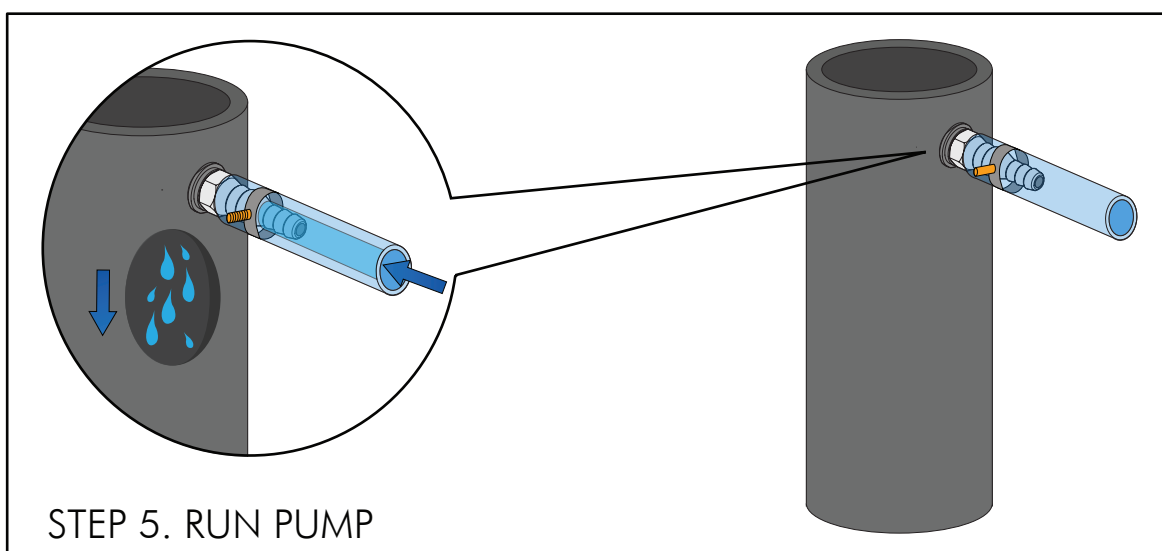
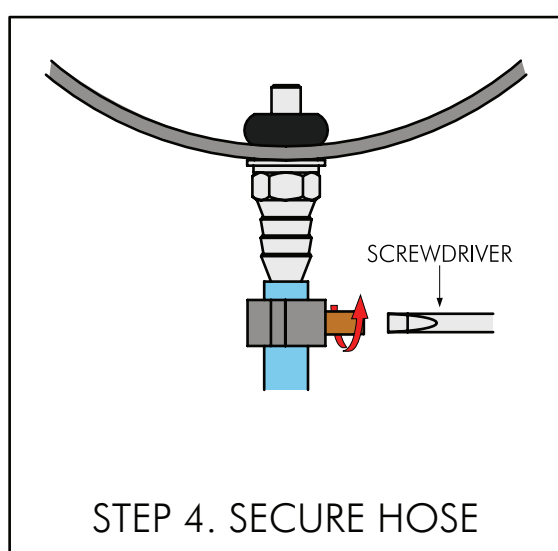
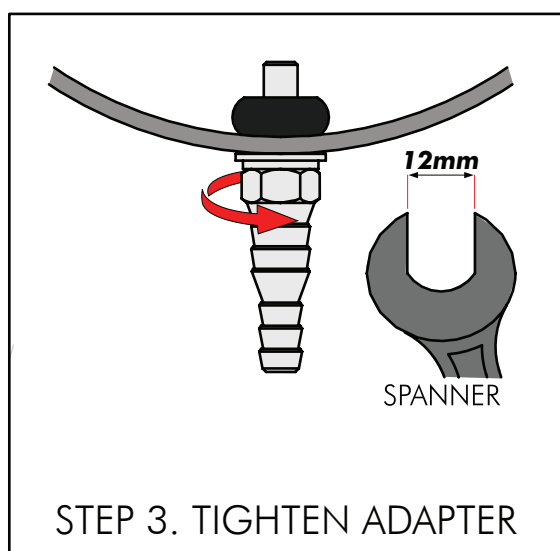
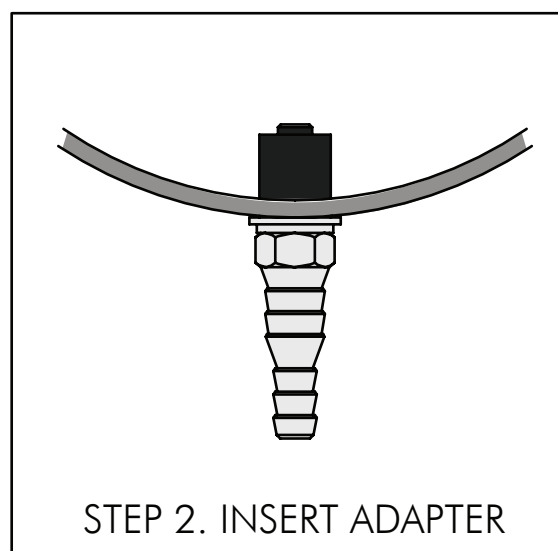
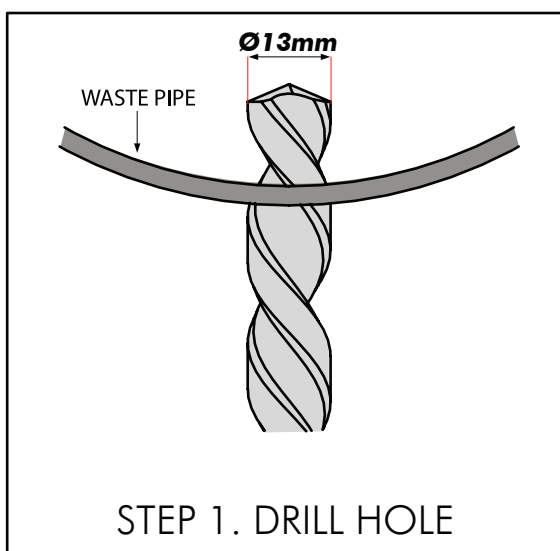



SAFETY INFORMATION

- Caution: Alarm lead must be connected to a class 2 circuit only –Do not connect to a load higher than 5A, 240v AC/DC.
- Caution: This pump has been evaluated for use with water only.
- Caution: Risk of electric shock: This pump has not been investigated for use in swimming pool or marine areas.
- Warning: Do not store, install or operate this pump in a damp environment.
- Warning: The unit must not be placed outside, immersed in water or exposed to frost.
- Warning: All existing collection elements and fittings should be thoroughly cleaned before installing. Do not install if damaged.
- Warning: Acceptable for indoor use only.